



Cassette awning

## markilux 900

The unique balcony awning  
with markilux folding arm technology to be fixed with accro bars.



reddot winner 2024  
best of the best



[markilux.com](https://markilux.com)

**markilux**  
safe timeless beautiful

Product Characteristics

Wind resistance class 2  
Beaufort 5 → 7.5–10.4 m/s → 28–37 km/h → 17–23 mph

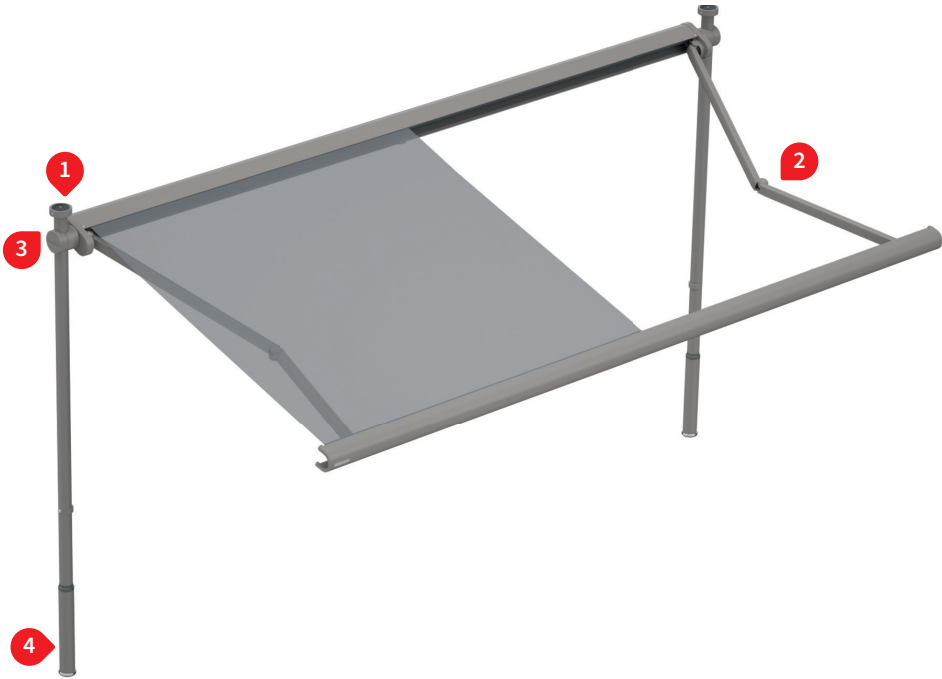

12

1 fixture with wedge-in accro bars



1 fixture with wedge-in accro bars, view from the rear, pitch 45 degrees



1 top fixture



1 top fixture, view from the rear



2 bionic tendon made of high-tech fibres for optimum power transference



awning retracted



during extension

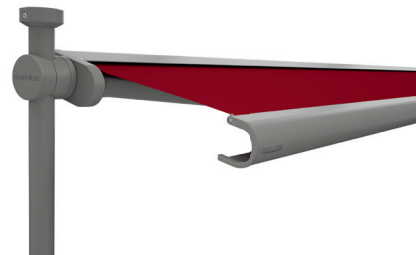

3 manual operation



4 cross section of a base with wedge-in accro bar



## Product characteristics

### Description

- Minimalist cassette awning with folding arms, installation possible with wedge-in accro bars, top fixture or eaves brackets

### Special features

- Compact cassette profile that lends an attractive appearance to the unit
- Cassette with arms situated at the front and at each end, which – when the awning is closed – are encompassed fully by the front profile lending a harmonious overall appearance to the awning
- Plenty of shade even when the awning is only slightly inclined – ideal for balconies For an unlimited sense of space with a clear view
- Generous pitch adjustment range of the awning from 5–70° – thus also suitable as protection against prying eyes
- Installation with wedge-in accro bars: convenient assembly/disassembly with few drill holes compared to conventional awning brackets
- The awning cassette is inserted into the holders of the particular fixture types, simple assembly
- Any unevenness of the installation surface can be levelled out thanks to the movable articulated base on the wedge-in accro bars The technical function is elegantly concealed and invisible
- Top-quality surface finish, profiles in façade quality, powder coated (including wedge-in accro bars)
- Wedge-in accro bars are also available in a different standard colour
- Cover can be selected from over 200 fabric patterns of the markilux collection to suit a range of different living styles

### Dimensions

- Cassette in the standard version: height 105 mm, depth 225 mm
- Single unit: width 200–400 cm, projection 150 cm or 200 cm
- Adjustment range wedge-in accro bar: 235–265 cm wedge-in height, on request 270–300 cm wedge-in height available

### Roller tube and lateral bearings

- Round roller tube Ø 63 mm with keyway, galvanised steel – excellent stability, ensures near perfect cover performance even at the largest widths

### Blind profiles

- Extruded aluminium, in façade quality, powder coated
- Single-piece cassette profile
- Semi-circular front profile

### Folding arms

- Profiles in extruded aluminium, in façade quality, powder coated
- Moving parts made of drop-forged aluminium – the arms are therefore extremely fracture resistant
- Pivot bolts in stainless steel run in Teflon-coated bronze bushes - practically maintenance free, virtually silent and extremely hard wearing
- Power transference via the innovative markilux bionic tendon at the elbow joint, made of high tensile, hightech fibres – low in friction, noiseless, impervious to corrosion and UV resistant, independently tested by the Fraunhofer Institute

### Side caps

- Two-piece side cap for the cassette made of top-quality plastic, powder coated
- Front profile end caps made of top-quality plastic, dyed-through, with water draining spouts

### Fixture

- Fixture with wedge-in accro bars, top fixture, eaves fixture
- Top fixture brackets with decorative covers, powder coated
- Wedge-in accro bars with brackets and articulated base, powder coated
- Railing securing for additional attachment of the wedge-in accro bars on the balcony railing, included in the scope of delivery by default

## Frame colours

markilux frame colours without a surcharge

traffic white, RAL 9016



stone grey metallic, 5215 <sup>1)</sup>



anthracite metallic, 5204 <sup>1)</sup>



### Special coating

Bespoke RAL colours incur a surcharge – matt, metallic and pearl finishes as well as other colour ranges (DB, Tiger etc.) on request. At a surcharge, all frame colours are available with enhanced corrosion protection.

Colours may differ slightly from those depicted in both hue and finish. In the case of special coating, dyed-to-the-core plastic parts may differ in colour.

**1)** textured finish

## Dimensions and configuration options

### Single unit

		Awning width					Minimum widths
		200	250	300	350	400	
Order di- mensions	194	194	201	251	301	351	
	200	200	250	300	350	400	
H	150	1)					194
	200		1)				244

1) = please note the minimum widths!

H = projection

 = 2 folding arms, 2 brackets

 = 2 standard arms

dimensions in cm

### Operation

	standard	optional
crank handle	✓	—
spring-assisted crank handle	—	—
hard-wired motor	—	✓
silentec motor (optionally with external radio receiver io / RTS)	—	—
radio-controlled motor io, 868 MHz	—	✓
radio-controlled motor RTS, 433 MHz	—	✓
868 MHz radio-controlled motor io with manual override	—	—

### Coupled awnings

not available

### Awning cover

	fabric pattern no.	standard	optional
sunvas	300.. – 315..	✓	—
sunsilk	324.. / 328.. / 369..	✓	—
sunbow	411.. – 427..	✓	—
smart art	340..	—	✓
perla FR	371.. / 372..	—	✓

### Shadeplus

not available

<b>Optional accessories</b>
Automatic controls (light, wind, rain)
For more detailed information, please refer to the chapter “Optional Accessories” in the main catalogue.

<b>Fixture options</b>	
clamp for wedge-in accro bar	62249.
cap for wedge-in accro bar	62250.
balcony securing	622601
top fixture bracket left	62247.
top fixture bracket right	62248.
eaves picture bracket 150 mm	75889.
eaves picture bracket 270 mm	71659.
angle and plate for eaves fixture machine finish aluminium, plate 500 mm	716620
spreader plate 260 × 60 × 12 mm for eaves fixture bracket	75383.

No. of brackets | No. of fixing points

Order dimensions		Awning width				
		200	250	300	350	400
		194 200	201 250	251 300	301 350	351 400
BHT		No. of brackets   No. of fixing points				
S	10	2   2				
DE	13,8	2   8				

12

Dimensions in cm

**BHT** = bracket width  
**DE** = top fixture brackets  
**S** = accro bar (contact surface diameter above under BHT)

Fixture range wedge-in accro bars

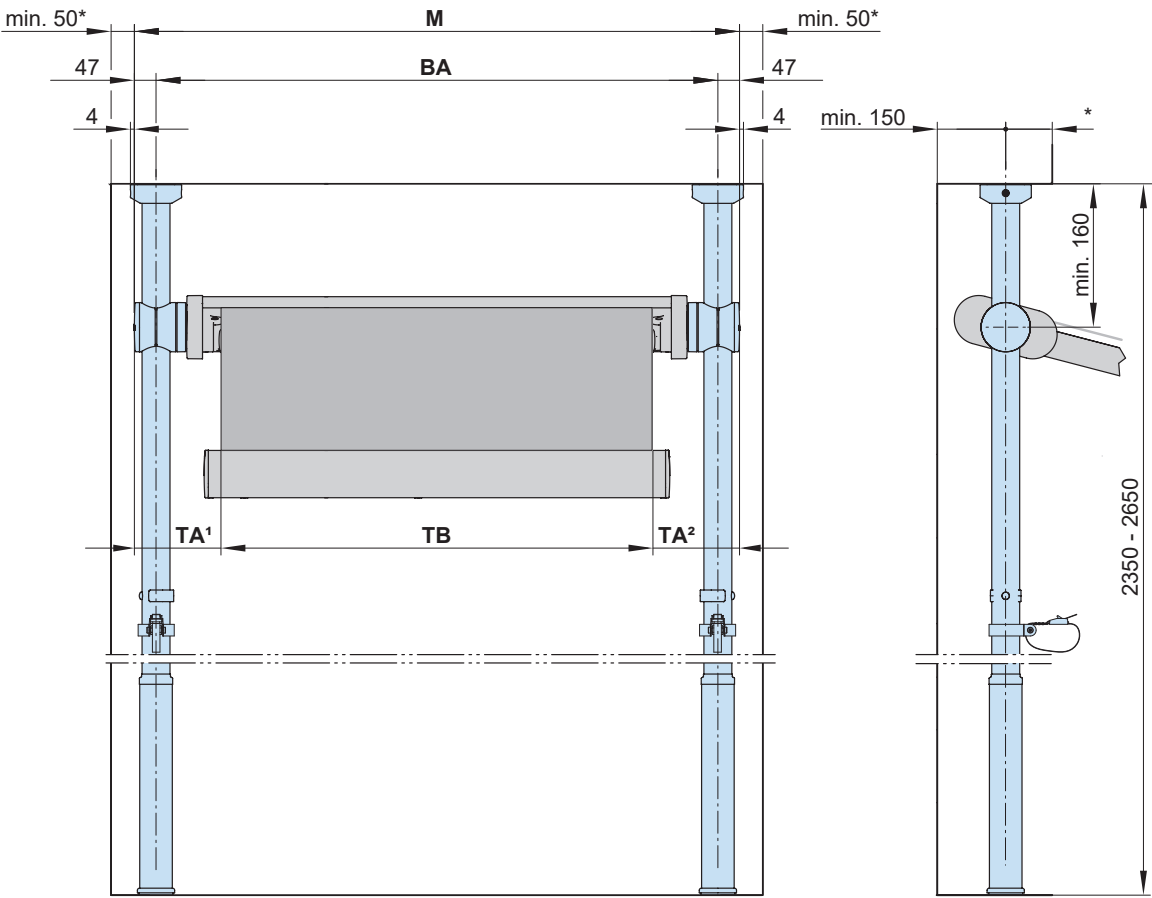

- \* = observe the minimum edge distance specified by the fixture material supplier
- AM = installation dimensions
- BA = fixture width
- M = **order dimension** = overall awning width

- TA<sup>1</sup> = cover width deductions  
with a motor = 189 mm  
with a gearbox (operating side left) = 205 mm
- TA<sup>2</sup> = cover width deductions  
with a motor = 189 mm  
with a gearbox (operating side left) = 189 mm
- TB = cover width = M - TA<sup>1</sup> - TA<sup>2</sup>

dimensions in mm



### Fixture range top fixture

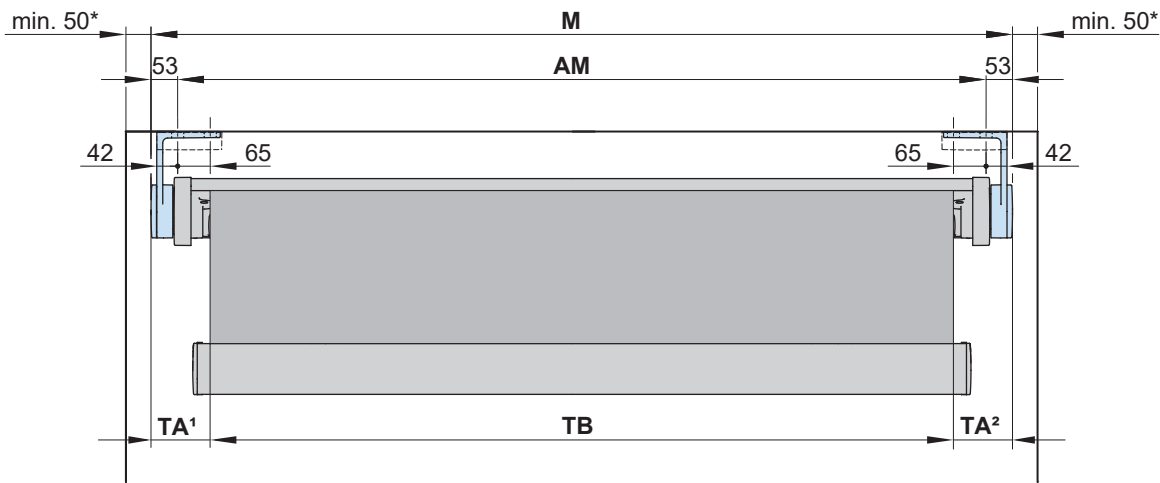

### 12 Fixture range eaves fixture

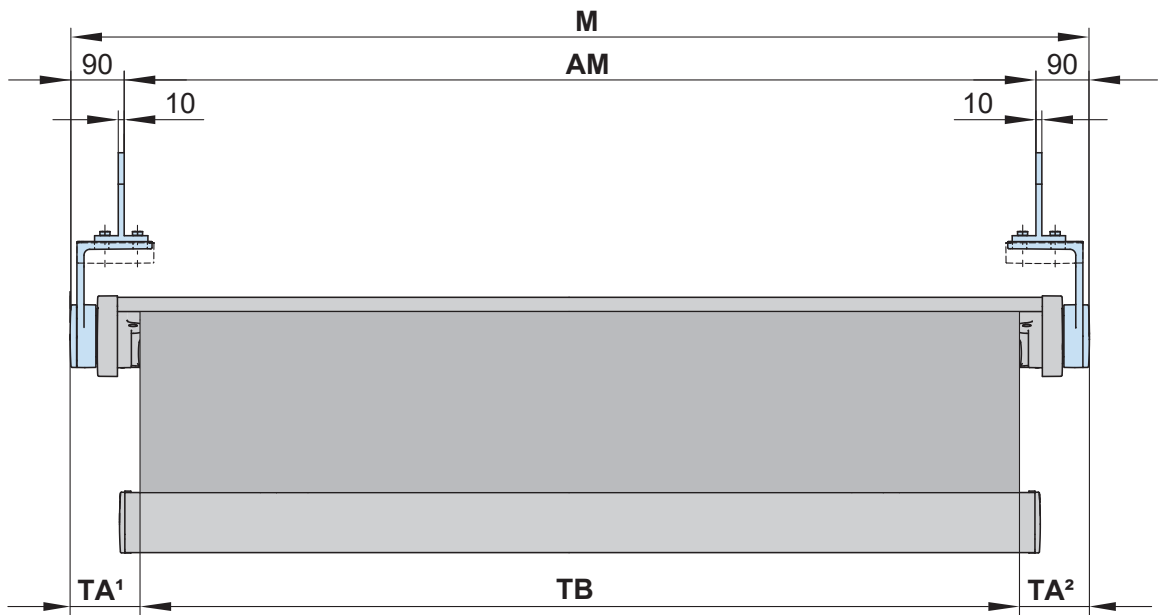

- \* = observe the minimum edge distance specified by the fixture material supplier
- AM = installation dimensions
- BA = fixture width
- M = **order dimension** = overall awning width

- TA¹ = cover width deductions  
with a motor = 123 mm  
with a gearbox (operating side left) = 139 mm
- TA² = cover width deductions  
with a motor = 123 mm  
with a gearbox (operating side left) = 123 mm
- TB = cover width = M - TA¹ - TA²

dimensions in mm



Fixture with wedge-in accro bars

Fixtures, fittings and accessories

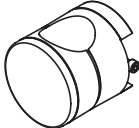

clamp for wedge-in accro bar

62249.

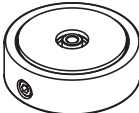

cap for wedge-in accro bar

62250.

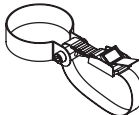

balcony securing 60 mm

622601



safety clip

62224.

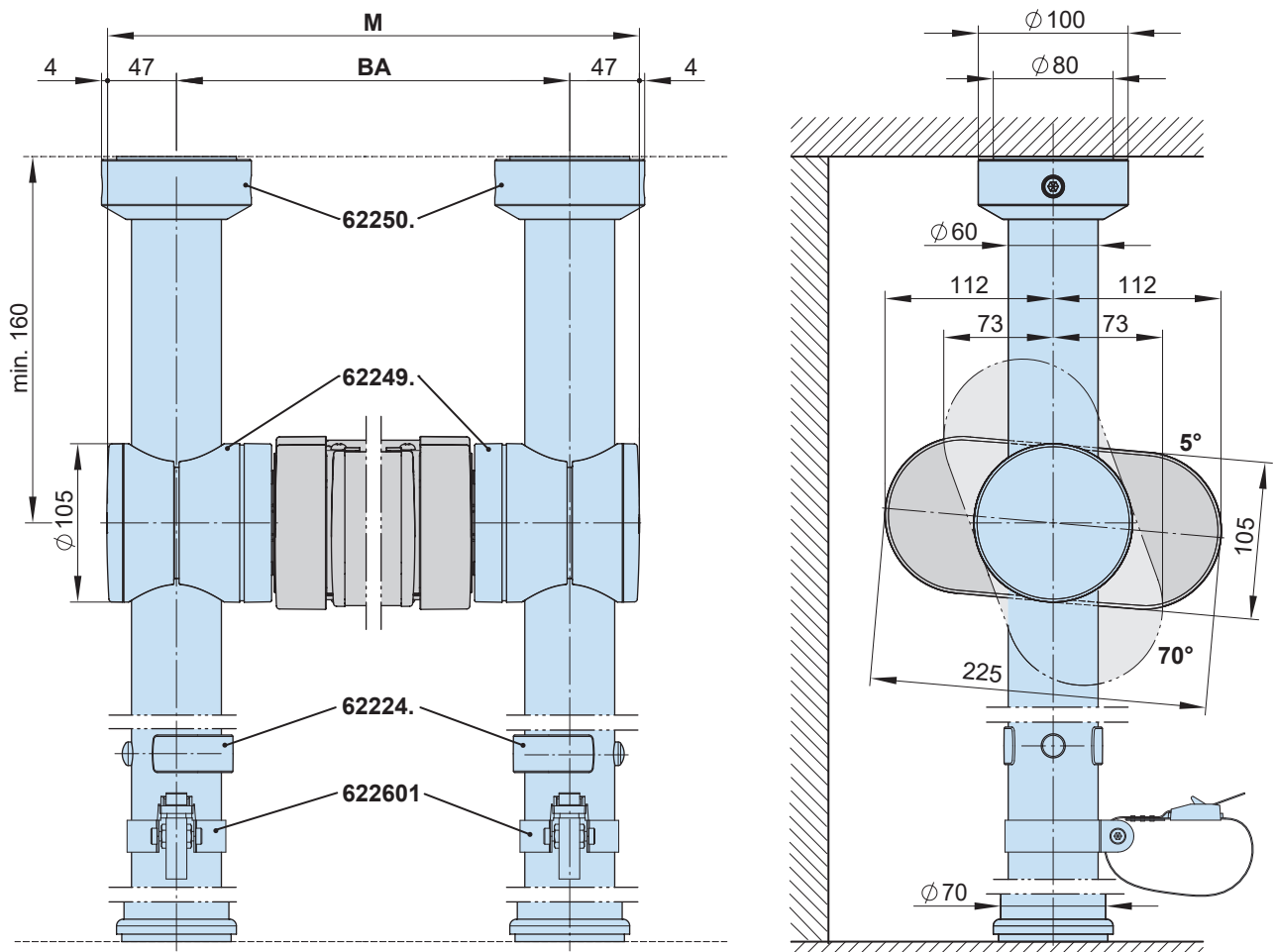

- 62224. = safety clip
- 62249. = clamp for wedge-in accro bar
- 62250. = cap for wedge-in accro bar
- 622601 = balcony securing
- BA = width between fixture points
- M = **order dimension** = overall awning width

dimensions in mm

## Fixture with wedge-in accro bars

Maximum height

Minimum height

Delivery state

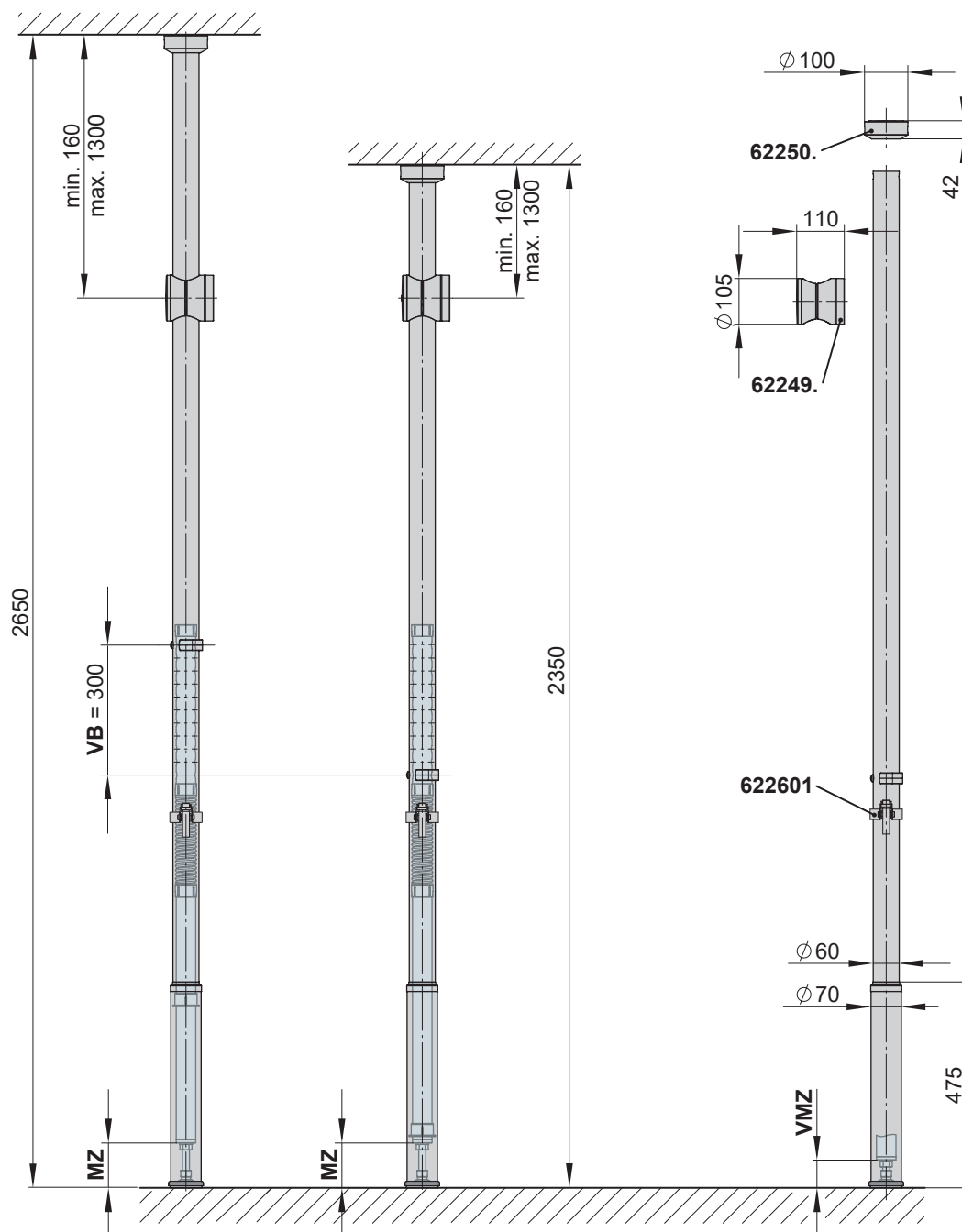

**Please note:** On request, the accro bars are also available with a wedge-in height of 270–300 cm.

**62249.** = clamp for wedge-in accro bar

**62250.** = cap for wedge-in accro bar

**622601** = balcony securing

**MZ** = assembled state

**VB** = adjustment range

**VMZ** = pre-assembled state

dimensions in mm

Top fixture

Fixtures, fittings and accessories

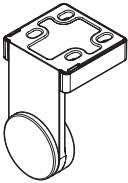

top fixture bracket  
left

62247.

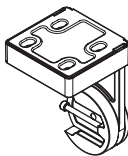

top fixture bracket  
right

62248.

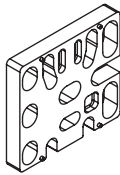

spacer plate  
for face/top fixture  
150 × 136 × 20 mm

716331

**N.B!**  
stack to a max. height of  
200 mm

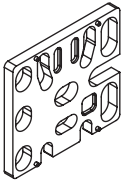

spacer plate for face  
fixture  
150 × 136 × 12 mm

71644.

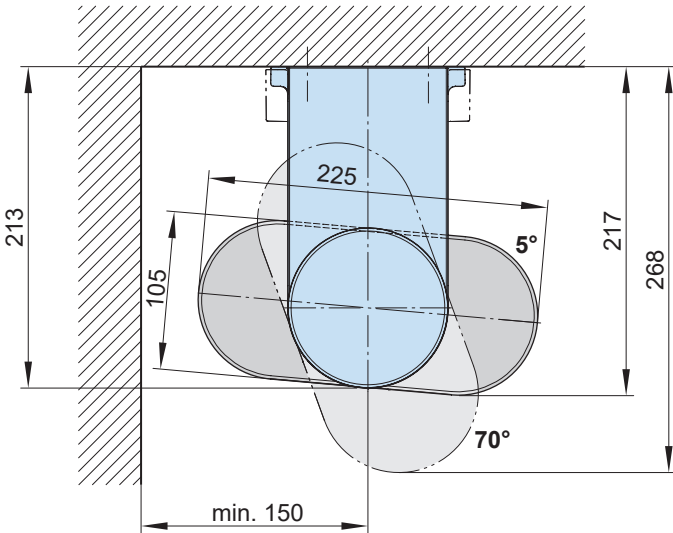
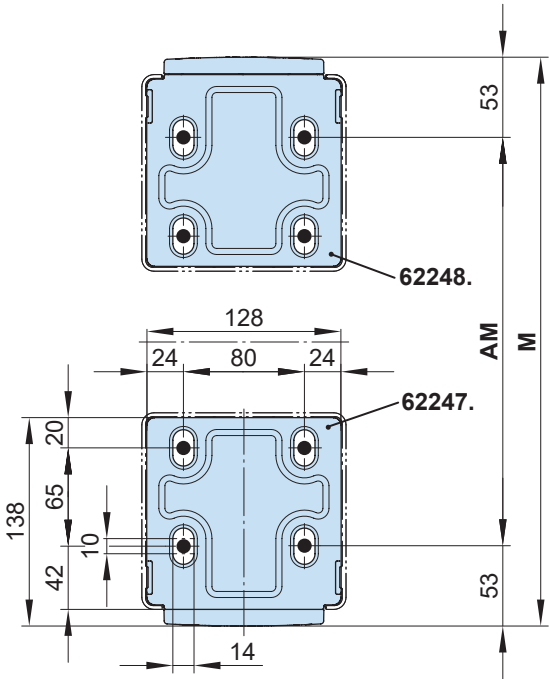

- 62247. = top fixture bracket, left
- 62248. = top fixture bracket, right
- AM = installation dimensions
- M = **order dimension** = overall awning width

dimensions in mm

Eaves fixture

Fixtures, fittings and accessories

eaves fixture bracket  
90 mm

150 mm plate

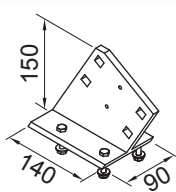

75889.

eaves fixture bracket  
90 mm

height of flat plate  
270 mm

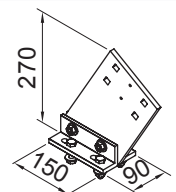

71659.

top fixture bracket  
left

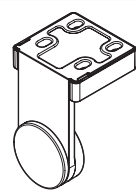

62247.

top fixture bracket  
right

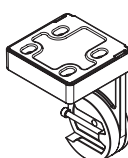

62248.

angle and plate for  
eaves fixture  
height of plate 500 mm

machine finish

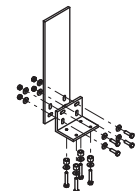

716620

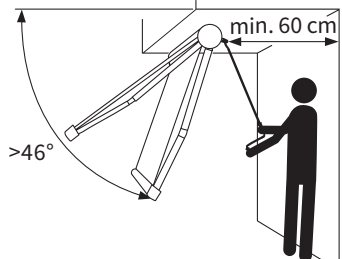

min. 60 cm

>46°

**N.B.!** At a pitch of more than 46° to the horizontal there must be an accessible area behind the awning at least 60 cm deep to allow manual operation incl. operation via radio-controlled motor with manual override. There are no limitations with motor systems.

With eaves fixture bracket 150 mm (75889.)

With eaves fixture bracket, top flat plate 270 mm (71659.)

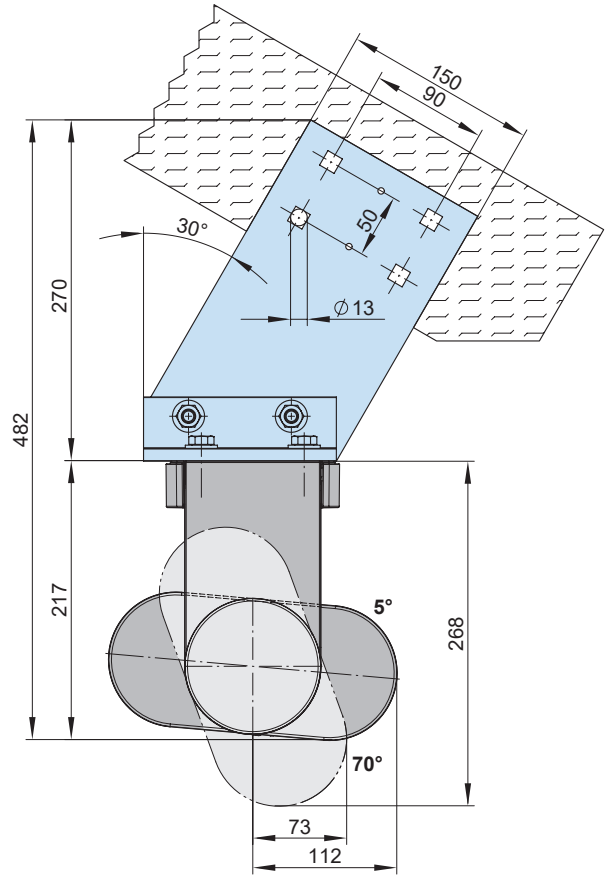
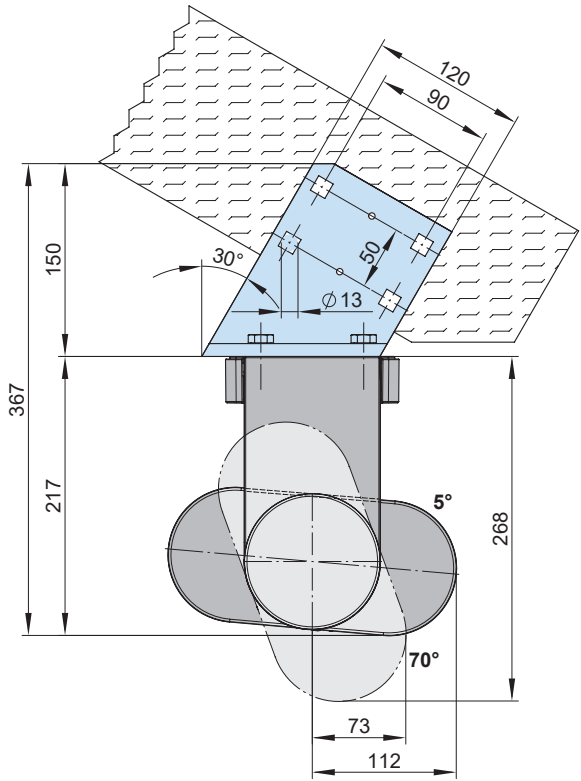

dimensions in mm

Eaves fixture with additional plate

Fixtures, fittings and accessories

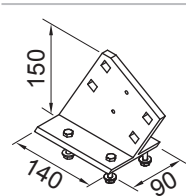

eaves fixture bracket  
90 mm

150 mm plate

75889.

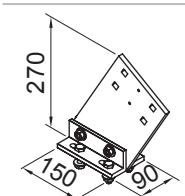

eaves fixture bracket  
90 mm

height of flat plate  
270 mm

71659.

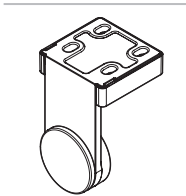

top fixture bracket  
left

62247.

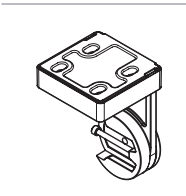

top fixture bracket  
right

62248.

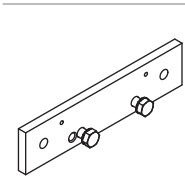

supplementary flat plate  
for eaves fixture

260 × 60 × 12 mm

75383.

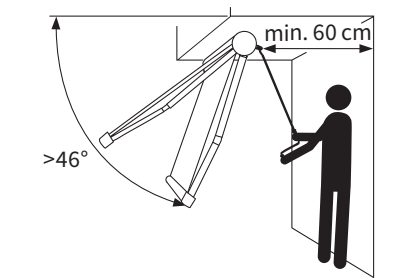

**N.B.!** At a pitch of more than 46° to the horizontal there must be an accessible area behind the awning at least 60 cm deep to allow manual operation incl. operation via radio-controlled motor with manual override. There are no limitations with motor systems.

With eaves fixture bracket 150 mm (75889.)

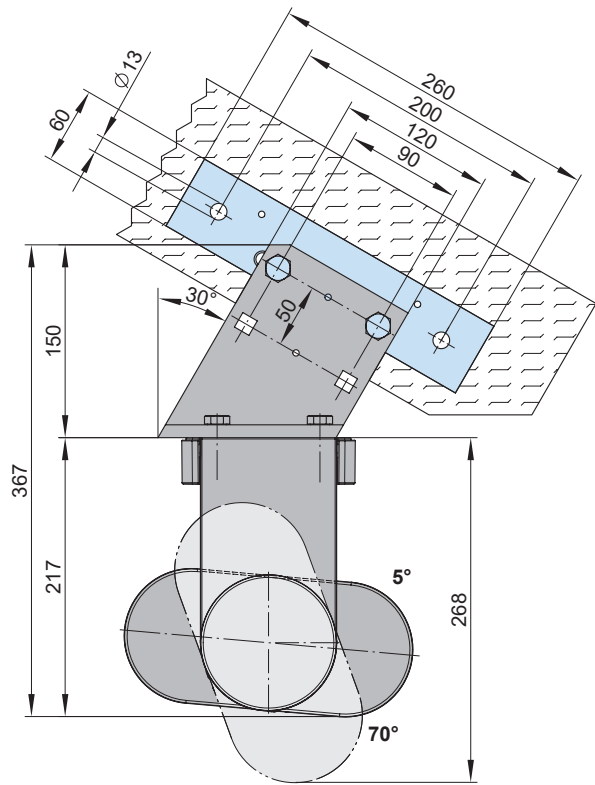

With eaves fixture bracket, top flat plate 270 mm (71659.)

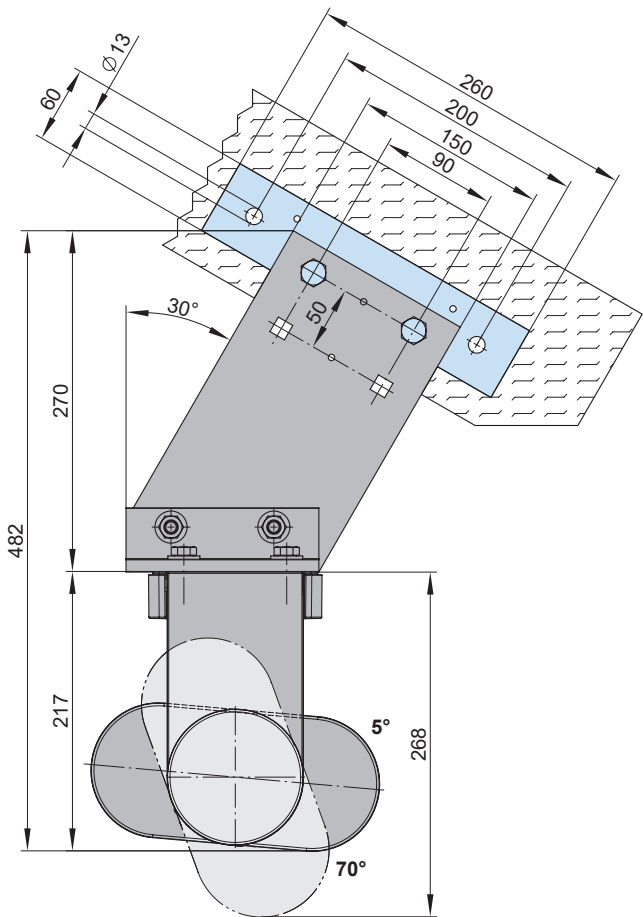

dimensions in mm

### Top fixture with gearbox

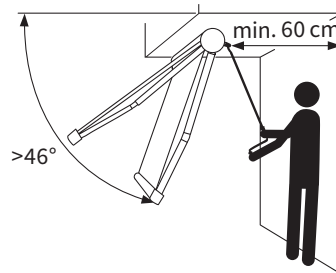
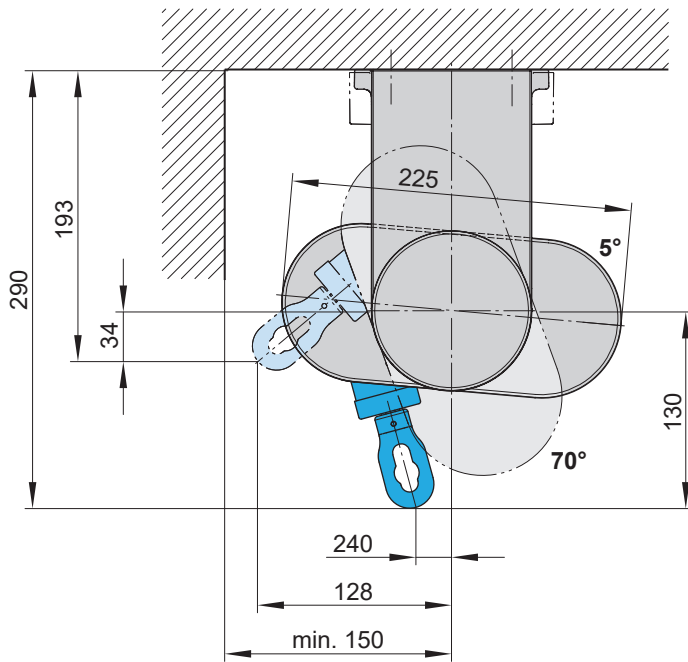

**N.B!** At a pitch of more than 46° to the horizontal there must be an accessible area behind the awning at least 60 cm deep to allow manual operation. There are no limitations with motor systems.

### Motor cable exit point

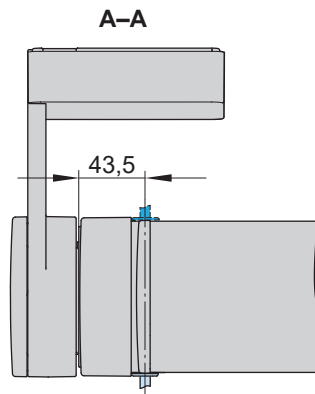
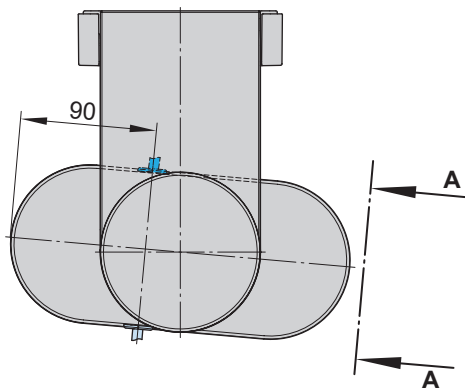

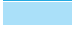
 = standard  
 = optional

dimensions in mm